

# Whitney Road and Marvell Family for Monitoring

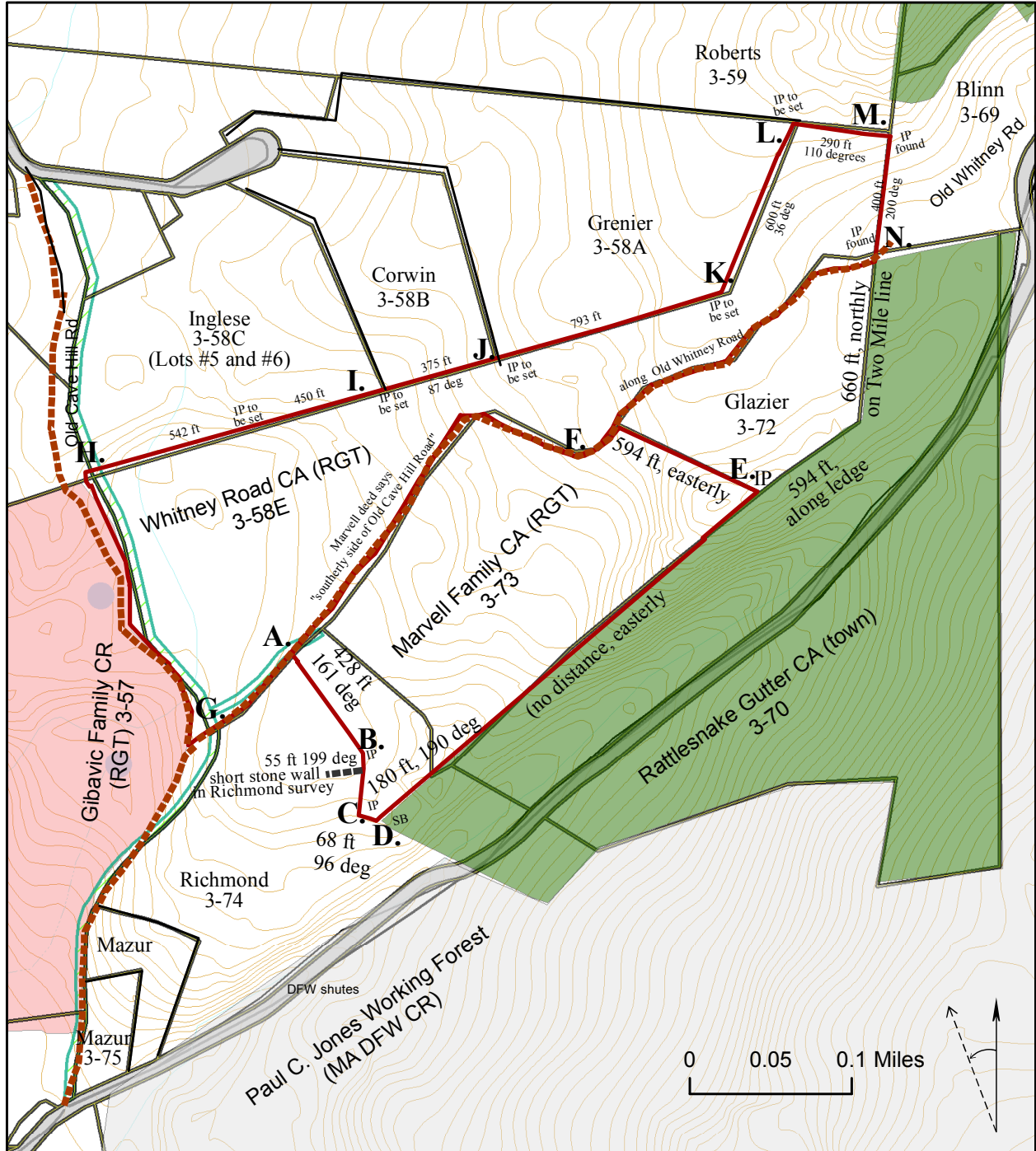

Note for Feb 9, 2011 that boundaries need to be re-gpsed.

In December 2014, in preparing map to match monitoring photographs, the capital letters for corners were revised (one set instead of two sets) and some lines were changed to conform with the most recent assessor's shape files. The location of the A-D line is about 80 feet east on the assessor's map. (Not changed, but needs to be checked.)