

RGT Monitoring Report: Stetson Adams Woodland

1. Name of Property and Year: Stetson Adams

2. Property owned by RGT?

a. If "no" (i.e. CR): Name of owner: Conservation Commission

b. Date owner was invited to join in the monitoring: Dave Powicki on November 5, 2014.

3. Date and recommendations from last year's monitoring: October 11, 2014

No follow-up needed; enjoy

4. Date of this year's monitoring: November 9, 2014

5. Participants: Laurie Brown (ConCom), Mary Alice Wilson (RGT)

6. Describe the monitoring route briefly (also draw on map):

From Rat Hollow Road went up Downy west road. Once at the property went clockwise along west, north, east and south line. (Orange flagging on south line incredibly helpful in late afternoon low light.)

7. Describe any man-made alterations

none observed

8. Describe any natural alternations:

none observed

9. If CR, describe any interactions with landowner(s) during the monitoring or since the past monitoring:

RGT and ConCom regular discuss conservation issues, but no around this property.

10. Describe any changes in use being planned (ownership? land use?):

none known

11. List any observations comments, areas needing discussion or review:

none known

12. List any needed follow-up:

We thought we saw both Gordon King pins along Rat Hollow on the way in. A gps reading was taken on the east pin. On the way back, the low afternoon light, made it impossible to find/gps the west pin. It was found the next morning, (see page 4.)

13. Suggestions for next year's monitoring team?

Bring photos of corner. SW easy to find because of flagging; NE has no pin, difficult; NE and SE easier, along the old Brushy Mountain Road, but bring new flagging next year. Also gps with shape file on machine.

It is a lovely spot, especially the field of stones as you approach the NW corner (photo). Enjoy.



Signed: _____

Date Signed:

- I have asked to present this report at the next RGT Board Meeting.
- I have sent a copy of this report to the owner (if CR).
- I have printed out a copy of this report and put it in the RGT green Field Notebook.
- I have sent a copy to the person who puts reports in the RGT blue Archive Notebook.
- I have sent an electronic copy of this report to the person who puts it on the Board-only section of the RGT website.

Stetson Adams Memorial Woodland Boundaries

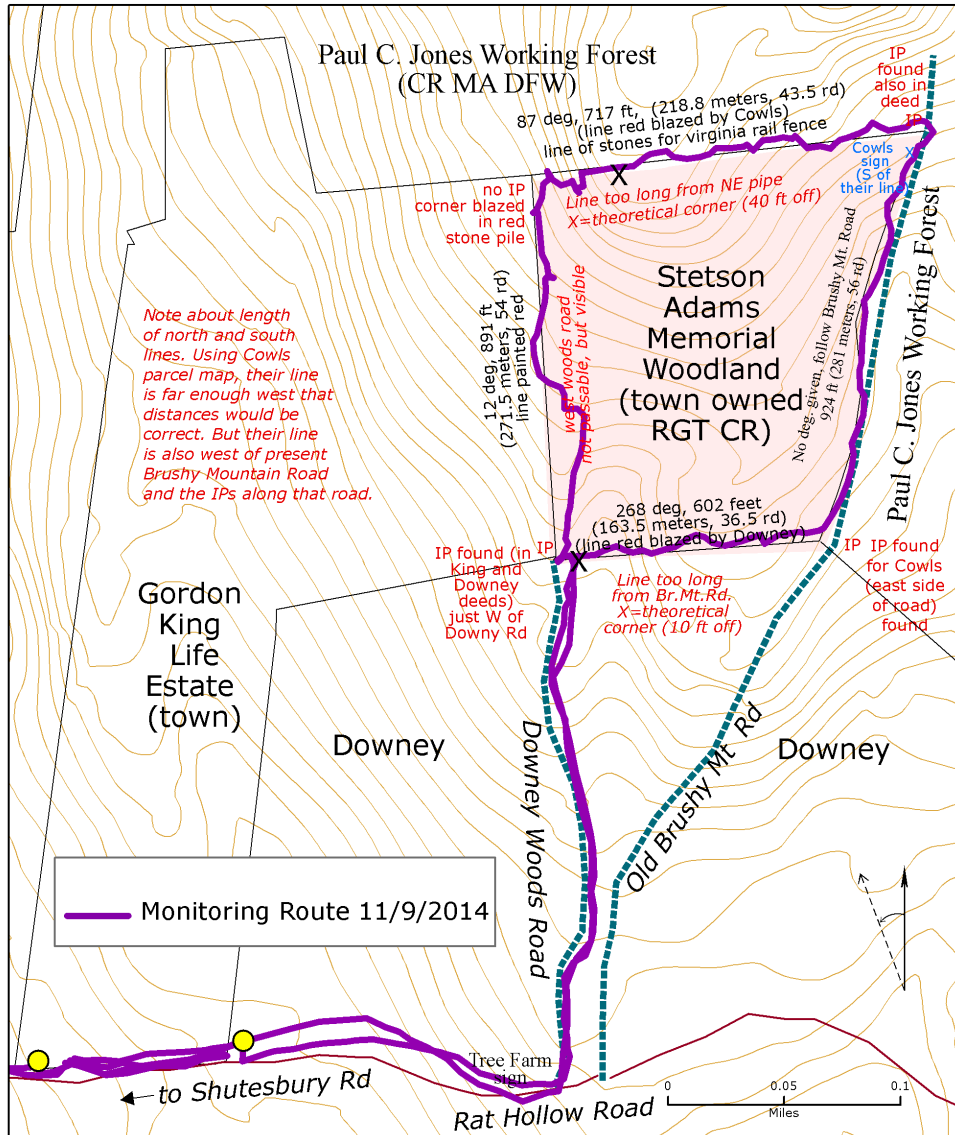

NE Corner: Cowls, Brushy Mt Rd, IP 42.4566, -72.4827 ip on west side of road
 SE Corner: Cowls, Downey, Brush Mt Rd, IP 42.4541, -72.4835 ip on east side of road
 SW Corner: Downey, GKing Life Est, 42.4540, -72.4857 ip west of road
 NW Corner: on Cowls line, no IP, 42.4563, -72.4859 pile of stones
 IP=iron (surveyor's) pipe
 GKing East IP=42.450978,-72.488383; West IP 42.45084, -72.490103

Note: this map is for monitoring, it is not a legal description of the property.

Note on Gordon King iron pins along Rat Hollow Road.

The east pin is easy to find because the next property (Downey, Gordon's grandson) is well marked with flagging and no trespassing signs.

The west pin is just across from the balcony of the house on the other side of the road (George Drake's). It is set back and, although re-flagged, is difficult to see.

