

Property: Stetson Adams Woodland	Year of this Report: 2013
Owner: name, address, phone, email if relevant (Also name of local contact if relevant.): ( <i>skip if owned</i> ) Leverett Conservation Commission	
Date owner invited to monitoring ( <i>skip if owned</i> ) Arranged during the week of the visit	
Date and recommendations from last year's monitoring: 10/26/2012	
<ol style="list-style-type: none"> <li>1. Improve the monitoring map to make it more helpful.</li> <li>2. Work on getting passive recreation access all along Rat Hollow Road (perhaps also though Downy property).</li> </ol>	
Date of this year's monitoring: 10/11/2013	
Participants: Mary Alice Wilson (RGT), Walter Ramsey (ConCom Agent)	
Brief description of route taken (also draw on map):	
<p>Walked Rat Hollow Road to Downey Wood Road, entered the property at the SW corner. Walked clockwise along the line. We had no trouble finding the 3 iron pipe corners and the pile of stones corner (NW). Conservation signs were nailed in as we walked. (The adjacent Gordon King Life Estate should probably also be signed so those walking the land will know that both areas are protected.)</p>	
Describe any man-made alterations (include on map, add photograph or "none observed"):	
None observed.	
<i>or .....none observed</i>	
Describe any natural alterations (include on map, add photographs or "none observed"):	
None observed.	
<i>or .....none observed</i>	
Describe any interactions (on day of site visit or in past year) with landowner or others having use of the land:	

<p>Members of the RGT Board serve on the Leverett Trails Committee, which is co-sponsored by RGT and the ConCom, so we are in regular contact. Conversations about this property have focused on getting private landowner's permission for passive recreation along Rat Hollow Road (which would open up this property to the public). A work in progress.</p>
<p>Describe any changes in use being planned (change of ownership, land use, etc.):</p> <p>None known.</p>
<p>List observations, comments, information requests, areas needing discussion or review:</p> <p>Except for the access issue, there are no problems.</p>
<p>List any needed follow-up:</p> <p>None needed.</p> <p>Blue boundary markers (Town of Leverett Conservation Area) were nailed to trees along the four boundaries and the map clarified so there should be no problems monitoring next year.</p>
<p>Suggestions for next year's monitoring team?</p> <p>Enjoy.</p>
<p>Signed: (Mary Alice Wilson</p> <p>Date signed: Oct 25, 2013</p> <p>10/16 Date report to RGT Board 10/25 Date copy sent to owner 10/25 date copy given for archive</p>

## Stetson Adams Memorial Woodland Boundaries

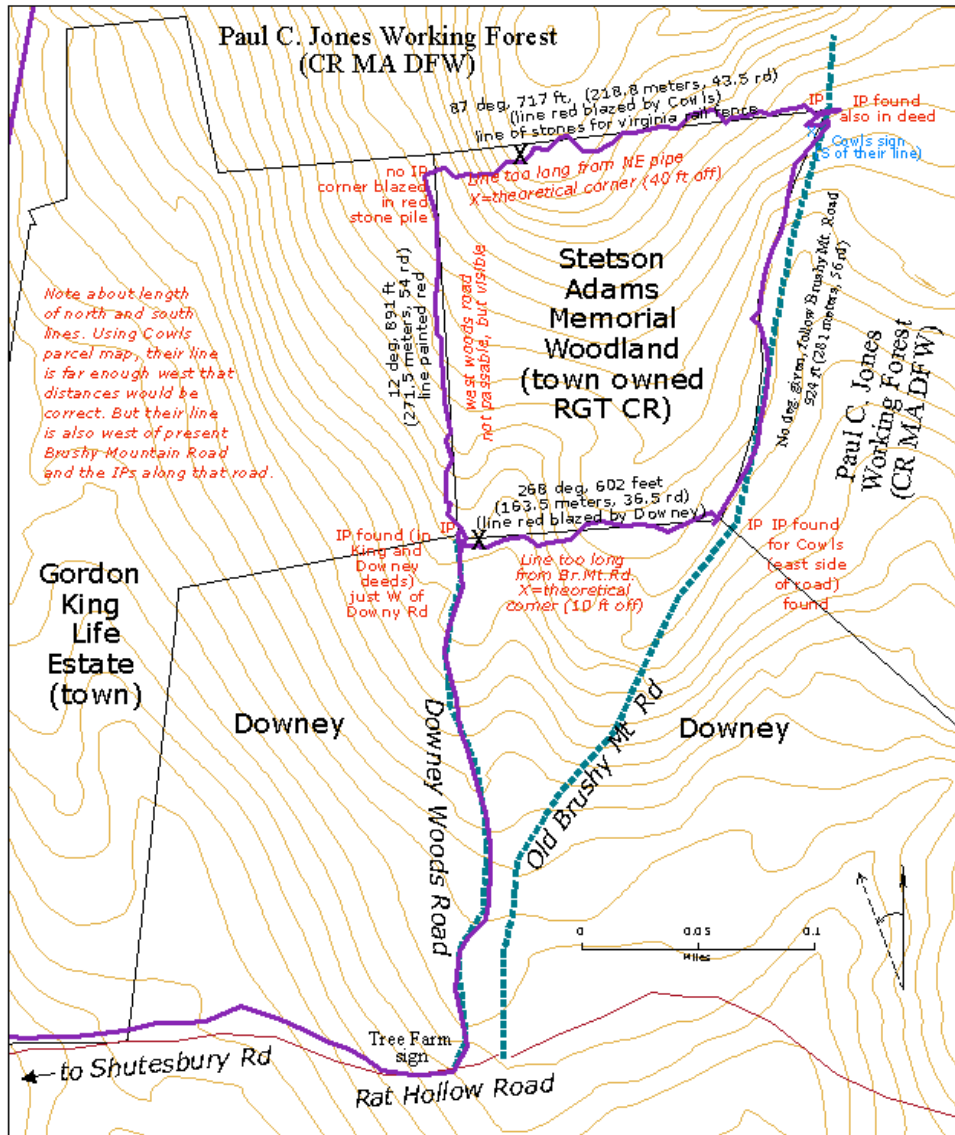

NE Corner: Cowls, Brushy Mt Rd, IP 42.4566, -72.4827 ip on west side of road  
 SE Corner: Cowls, Downey, Brush Mt Rd, IP 42.4541, -72.4835 ip on east side of road  
 SW Corner: Downey, GKing Life Est, 42.4540, -72.4857 ip west of road  
 NW Corner: on Cowls line, no IP, 42.4563, -72.4859 pile of stones  
 IP=iron (surveyor's) pipe  
 Monitoring Track, October 11, 2013

Note: this map is for monitoring, it is not a legal description of the property.