

Rattlesnake Gutter Trust Monitoring - RGT-Owned Property Form

1. Property Name: Scheffey Conservation Area

Year: 2019

2. Date of Monitoring: 12/28/2019

Recommendations from last year's monitoring:

Bring heavy duty trash bags and gloves to pick up trash along Shutesbury Rd. Traffic is dangerous along road curves. Choose a low traffic time. Wear blaze orange. Bring blue tree tagging tape to renew border markings in a few spots.

3. Monitors:

Dan Williams. Joan Godsey and neighbors Rick Pouliot and Lisa Brooks were unable to attend.

4. Describe the monitoring route briefly (also draw on map):

Began at northeast corner parking area at Shutesbury town line. Hiked into woods from parking area to northeast corner boundary. Explored northeast corner of bordering Scheffey property (Franklin Land Trust) then rejoined south border and walked west. Continued walking clockwise around property boundary. Picked up some trash along Shutesbury Rd.

5. Action Items requiring attention:

None.

6. List any problems with monitoring map or photos:

None. Noted evidence of logging just south of south border on neighboring Scheffey property (Franklin Land Trust) between points B and D on map. No incursions onto RGT property.

7. Describe alterations. Draw on map, take photos.

Natural

None Observed:

Human Made

None Observed:

Rattlesnake Gutter Trust Monitoring - RGT-Owned Property Form

8. Monitoring recommendations for next year:

Bring trash bags, gloves to pick up trash along Shutesbury Rd. Traffic is dangerous along road curves. Choose a low traffic time. Wear blaze orange. Bring blue tree tagging tape to renew border markings in a few spots.

Stewardship Plan for Upcoming Year:

9. Last Year's Stewardship Plan / Goals / Accomplishments:

Trash pick-up along Shutesbury Road.

10. Last Year's Actual Costs \$0

11. Goals, planned activities to meet those Stewardship goals and timeline for the coming year:

Trash pick-up along Shutesbury Road during annual monitoring. No additional stewardship activities planned for 2020.

12. Anticipated costs (both on-going and for this next year):

\$10 for trash bags

Signed:



Date Signed: 01 JAN 2020

Still to do:

- Ask to present this report at the next RGT Board Meeting
- Print out and sign 3 copies:
 - 1. Put one in the Green Field Notebook
 - 2. Give one to the person who puts the reports in the Blue Archive Notebook at the Leverett Family Museum.
 - 3. Mail (or give) a copy to the land owner(s)
- Send an electronic copy of this report to the person who puts it on the Board-only section of the RGT website.

Updated 1/17/15

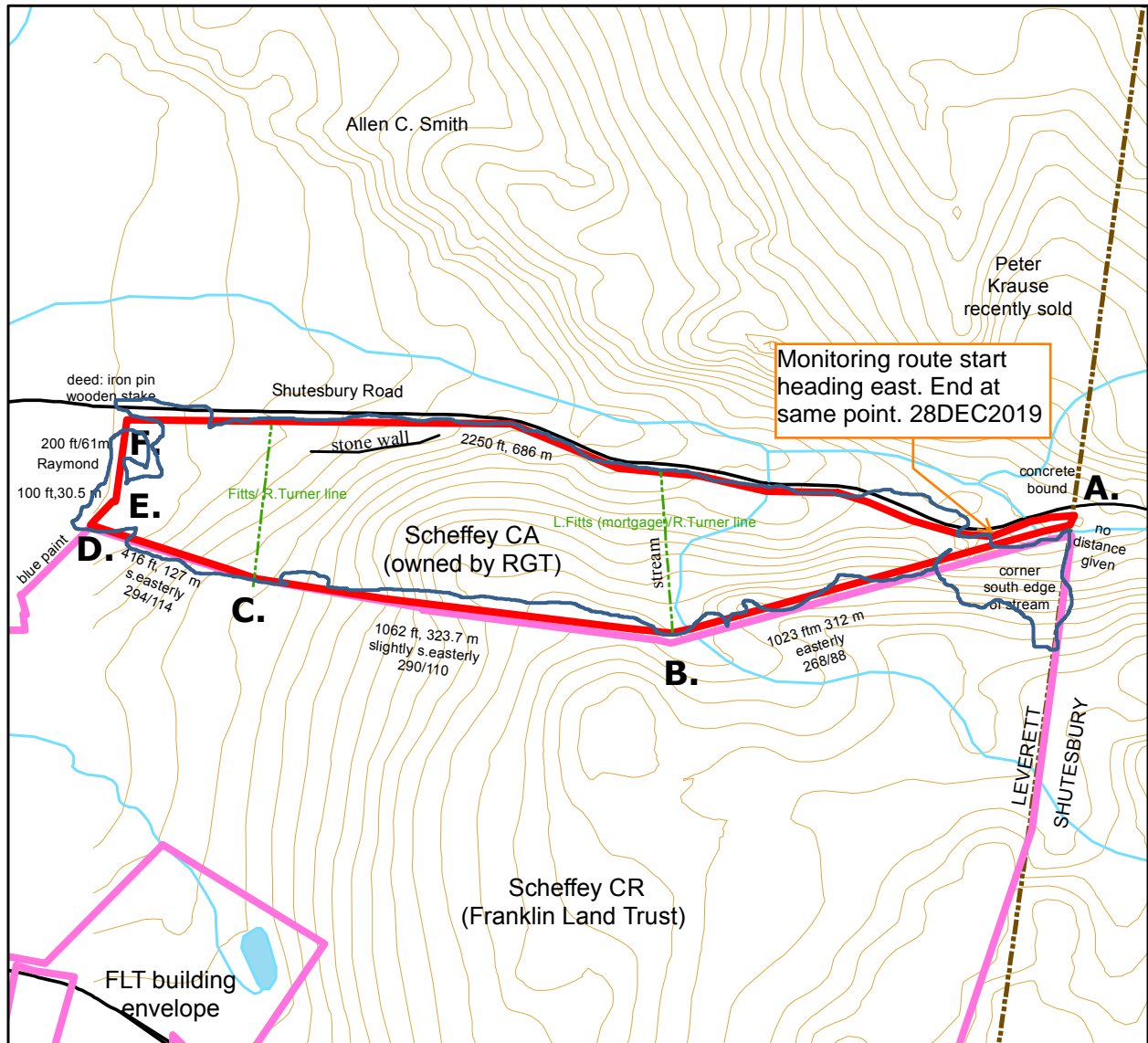

Scheffey Conservation Area (RGT) for Monitoring

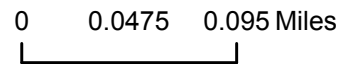

- NE corner: 42.4497, -72.4511 (by stream and town line sign)
- back S E corner: 42.4488, -72.4548 (just west of stream, slight turn)
- back S W corner: 42.4491, -72.4587 (slight turn)
- S W corner: 42.4496, -72.4604 (at fence, by farm pond)
- S Mid point: 42.4497, -72.4602 (turn by fence, not stake)
- NW corner: 42.4503, -72.4600 (stake in stone wall)

- W edge stone wall: 42.4501, -72.4583
- E end stone wall: 42.4502, -72.45717

South and East boundary blazed with red paint (corners 3 dots), 4/2/2010