

Property: Scheffey Conservation Area      Year of this Report: 2013
Owner: name, address, phone, email if relevant (Also name of local contact if relevant.): <i>(skip if owned)</i>
Date owner invited to monitoring <i>(skip if owned)</i>
Date and recommendations from last year's monitoring: July 20, 2012  bring at least 3 large trash bags and gloves.  Check Raymond/access area (as always)
Date of this year's monitoring: Sunday, October 27, 2013
Participants: Joan Godsey, Mary Alice Wilson
Brief description of route taken (also draw on map):  Starting at the Shutesbury line, went uphill along southern border, down beside Raymond's on the west side and back along the road picking up trash.
Describe any man-made alterations (include on map, add photograph or "none observed"):  None observed
Describe any natural alterations (include on map, add photographs or "none observed"):  None observed
Describe any interactions (on day of site visit or in past year) with landowner or others having use of the land:  None. Some years Mr. Raymond has been outside and we have talked with him. We did not see him on this trip. Alice Scheffey was told about the trip during a casual conversation the day before.

Describe any changes in use being planned (change of ownership, land use, etc.):

None known

List observations, comments, information requests, areas needing discussion or review:

Some years there has been a concern about parking vehicles in the right-of-way area next to the Raymond's. The number of vehicles has decreased through the years and this year there were none.

After one of the major storms, some cuttings from the many fallen trees were hauled to the back of the woods road next to the Raymond's. That pile has not been added to.

We checked the other short woods roads that lead in from the property and did not find any trash or damage.

There were lots of bottles, cans, styrofoam cups, etc. along the road. (We may not have done the trash pickup last year.) The non-returnables construction-size plastic bag was full and heavy. The possibly returnable smaller white garbage can bag was full.

List any needed follow-up:

The red paint is fading, needs to be repainted next year.

Suggestions for next year's monitoring team?

Trip, with the trash pickup takes two hours. Bring heavy-duty bags and gloves. Walk up all roads/trails from Shutesbury Road to check for trash (these spurs never go far).

And bring red paint (and map, compass, and gps is available).

It is a lovely walk along the side of the hill; the stream is especially lovely.

Signed:

Date signed:

..... Date report to RGT Board ..... Date copy sent to owner ..... date copy given for archive

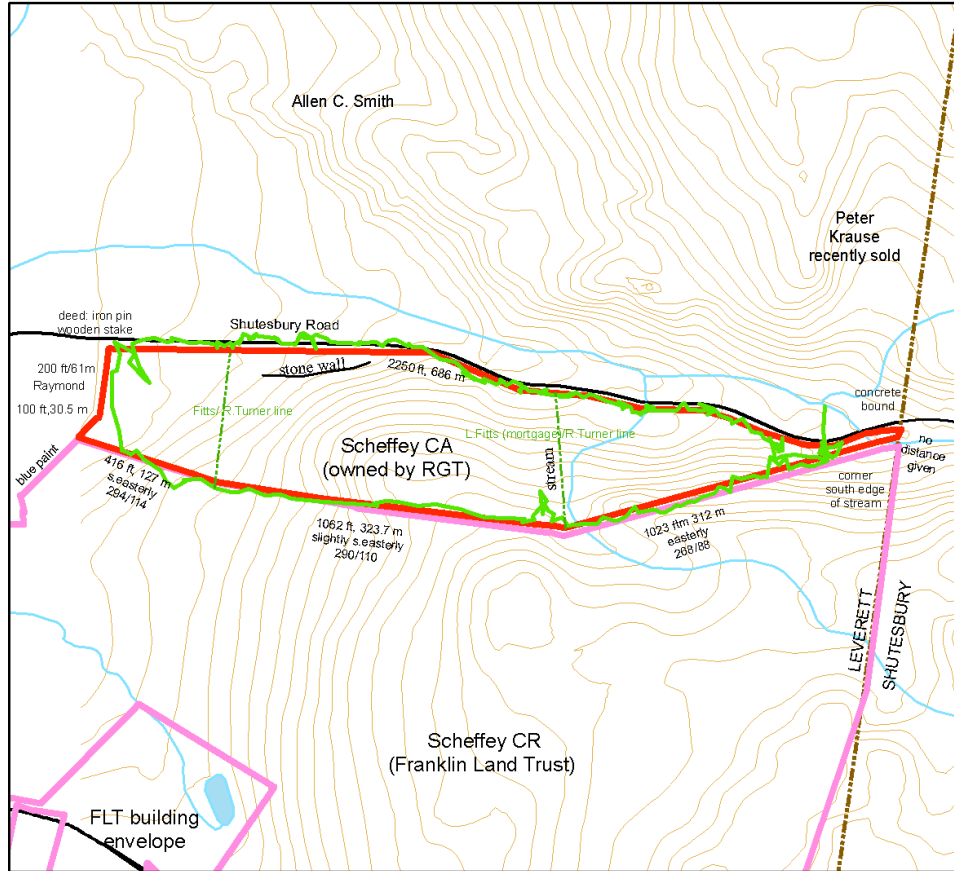

Scheffey Conservation Area (RGT)  
Monitoring October 27, 2013 (green track)

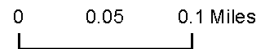

NE corner: 42.4497, -72.4511 (by stream and town line sign)  
 back S E corner: 42.4488, -72.4548 (just west of stream, slight turn)  
 back S W corner: 42.4491, -72.4587 (slight turn)  
 S W corner: 42.4496, -72.4604 (at fence, by farm pond)  
 S Mid point: 42.4497, -72.4602 (turn by fence, not stake)  
 NW corner: 42.4503, -72.4600 (stake in stone wall)

W edge stone wall: 42.4501, -72.4583  
 E end stone wall: 42.4502, -72.45717

South and East boundary blazed with red paint (corners 3 dots), 4/2/2010