

Archive Notebook copy\_\_\_\_\_

Field Notebook copy\_\_\_\_\_

If CR, owner's copy\_\_\_\_\_

## **Rattlesnake Gutter Trust Monitoring Report**

Property/Conservation Restriction Name: \_Scheffey Conservation Area

Date of visit(s): August 31, 2011 CR?\_\_\_\_\_ Owned by RGT?\_yes\_\_\_

IF CR please complete this information, if owned property skip to #1:

Current owner(s):

Address(es):

Telephone:

Email:

Local Contact if different from owner:

1. In preparation for the visit

- a. date of previous visit: 3/19, 3/20, 4/2 – walking line and marking it with Franklin Land Trust
- b. special concerns listed from previous visits that need to be checked – use of “access” area by neighbor; exactly where southern line was (solved and marked)

c. IF CR, was the land owner contacted prior to monitoring? (if yes, give date and whether by phone, email, etc; if not, why not?)

2. Participants attending site visit (IF CR include land owner if present): Joan Godsey, Mary Alice Wilson, Bill Wilson

3. Please use monitoring map (attached) to

- a. show the path of the visit
- b. mark any issues brought up in this report.
- c. suggest changes in information on next year's map

4. Describe any man-made alterations since the last monitoring visit. Describe extent, location, purpose, and person responsible (if known). Mark on attached map; add photographs or illustrations if helpful. (Be sure to check roadside areas for possible dumping/disturbance.)

Seems to be more use of access area by Raymonds, see pictures

5. Describe natural alterations since previous visit (effects of flood, fire, insect infestation, ice damage, etc.) Note extent and location. Mark on attached map; add photographs or illustrations if helpful.

None noticed

6. Describe any interactions (on day of site visit or in past year) with landowner or others having use of the land.

None that day, sent email to Liz Scheffey and Will Anderson

7. IF CR, describe any information that property will be transferred, leased, or sold. Are any changes in use being planned?

na

8. List observations, comments, management needs, information requests, areas needing discussion or review:

Last year we marked border with red blazes. This year we added the new RGT metal border markers. (Along Raymond land put them on trees on east side of path mowed along line.)

At RGT meeting some time ago we talked about letter to neighbor Bertrand Raymond saying that present use of right of way has our permission, but that it will be withdrawn when ownership changes. Mr Raymond would then sign the letter and we would both keep copies. That needs to be pursued.

9. List any needed follow-up

We ran out of RGT boundary markers, Mary Alice returned on Sept 2<sup>nd</sup> to complete roadside markers.

There is always trash. Picking it up is part of the joy of this walk.

10. Suggestions for next year's monitoring team?

Assuming letter is done this year, just check for red paint markers (might need to be re-done, and occasional boundary markers). Oh, and pick up the trash (one bag for clean enough and appropriate for recycle, another – 1 or 2 – for the rest. Take gloves.



(left) Standing on western line (fence posts are on the line) looking south.

(right) Taken same location (next to shed) looking north toward road.



(left) Standing along Shutesbury Road looking southwest along access road across Sheffey CA to the Raymond property. Joan is putting up RGT boundary markers

(right) Close up of the bus.

Signed \_\_\_\_\_ date \_\_\_\_\_

Date report submitted to RGT Board for Review: \_\_\_\_\_

Date report placed in Field Notebook \_\_\_\_\_

Date second copy brought to Board Meeting for Archive Notebook \_\_\_\_\_

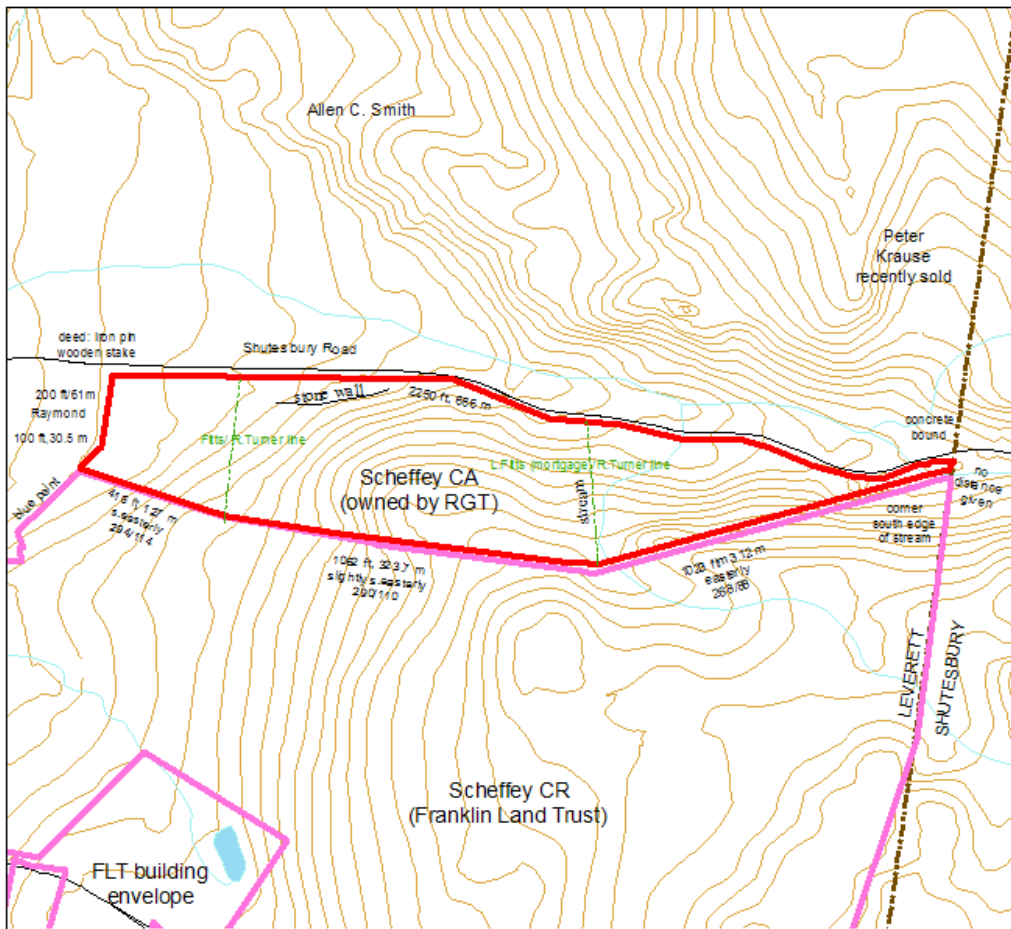

Scheffey Conservation Area (RGT)  
for Monitoring

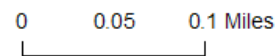
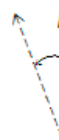

NE corner: 42.4497, -72.4511  
 back S E corner: 42.4488, -72.4548  
 back S W corner: 42.4491, -72.4587  
 S W corner: 42.4496, -72.4604  
 S Mid point: 42.4497, -72.4602  
 NE corner: 42.4503, -72.4600

W edge stone wall: 42.4501, -72.4583  
 E end stone wall: 42.4502, -72.45717

South and East boundary blazed with red paint, 4/2/2010

August 31, 2011. Went, as usual, from parking lot clockwise up the hill, down to the west line and back to the road. Picked up trash coming back along the road. Much of interior visible from boundary, but did not do interior monitoring.