

RGT Monitoring Report Form 2014

a. Please save this form with the name of the property and the year - for example: Bates Monitoring Report 2014. Do this now and continue to save it. (If you don't do it, it will be hard to sort out all the Monitoring Reports later)

b. Fill out 1, 2, and especially 3 WHEN YOU ARE PLANNING the trip.

1. Name of Property and Year: Mosher 2014

2. Property owned by RGT? Yes

If "no" (i.e. CR): Name of owner (if new owner, put in all the contact information. If same just put in name):

Date owner was invited to join in the monitoring:

3. Date and recommendations from last year's monitoring:

No written report submitted 2013. Glen Ayers discussed his visit briefly at RGT meeting - all fine. East line (boundary with Kosloski) he repainted yellow. North and west line (Cowls) need to be repainted - Cowls red line has not repainted in years. South line (Smith) needs to be repainted (white fading). Shelter fine, very little use, always needs to be checked.

4. Date of this year's monitoring:

Boundary walked July 31, 2014. North and most of east line repainted yellow August 19 (when Smith line being repainted), final small section of east line (Cowls) repainted yellow August 24.

5. Participants:

7/31 Mary Alice Wilson, Eva Gibavic, Rocky and Anne Adriance; 8/18 Bill and Mary Alice Wilson; 8/24 Mary Alice Wilson

Connie Peterson invited (as AMC monitor of the shelter) but was away. A fall walk with her is planned.

6. Describe the monitoring route briefly (*also draw on map*):

Walked up former M-M trail/white-dot trail to Rat Hollow Road. Turned north along Smith boundary. Then east following stone wall until in sight of

AMC shelter. Visited shelter then back to Smith (white-painted) line to the stake and stones. Turned north along the yellow-painted Kosloski line (difficult to follow through the mountain laurel) to the stake and stone (Cowls corner). Then west along the Cowls blazes (red paint very faded, but Virginia Rail Fence easy to follow). At the woods road on the Cowls property turned south - the line is just to the east of that road.

7. Describe any man-made alterations (*draw on map/take photos. If no, write "no observed"*):

AMC shelter and privy in good condition. The journal on the shelf indicated very little use. (On 8/15 while painting the Smith boundary we observed 4 young men packing into the shelter - probably from a car parked on Shutesbury Road.

8. Describe any natural alternations: None.

9. If CR, describe any interactions with landowner(s) during the monitoring or since the past monitoring: NA

10. Describe any changes in use being planned (ownership? land use?): None

11. List any observations comments, areas needing discussion or review:

AMC shelter is in good shape - primarily because it is not often used.

12. List any needed follow-up:

Do need to walk shelter area with Connie Peterson (planned for fall)

13. Suggestions for next year's monitoring team?

South boundary (Smith) is painted white with a brush and should be fine for a number of years. All other boundaries were spray-painted yellow (east in 2013; north and west in 2014). They will need repainted within a few years.

Always check shelter.

The north Virginia Rail Fence boundary is especially interesting. (stack of stones used as the base for interlocking rail horizontal fence pieces - these fences were easier/quicker to build than stone walls - over the years they were replaced with barbed wire but only if the area was still used as pasture. (There is lots of barbed wire along the east edge of the Smith property especially south of Rat Hollow Road and the first stonewall area.) See photos.

Signed: Rocky Adriance and Mary Alice Wilson

Date Signed: Aug 10, 2014 and August 24, 2014

I have asked to present this report at the next RGT Board meeting

I have printed out a copy of this report and put in the RGT green Field Notebook

I have given a copy to the person who puts reports in the RGT blue Archive Notebook

I have sent an electronic copy to the person who puts it on the Board-only section of the RGT website.

Monitoring Photos by Eva Gibavic, Mosher Monitoring Walk July 31, 2014: Eva, Anne and Rocky Adriance, Mary Alice Wilson



Shelter and Outhouse

All appeared to be in good condition

(and not often used).



SE corner (bordering Smith CR and Kosloski)



Above: N line, Virginia Rail Fence Stones. Trees blazed by Cowls, but red paint has faded.

Right: NW corner marker with Cowls. The line is just E of Cowls' wood road.

More photographs in previous monitoring reports and in the Baseline Documentation, Part 2.



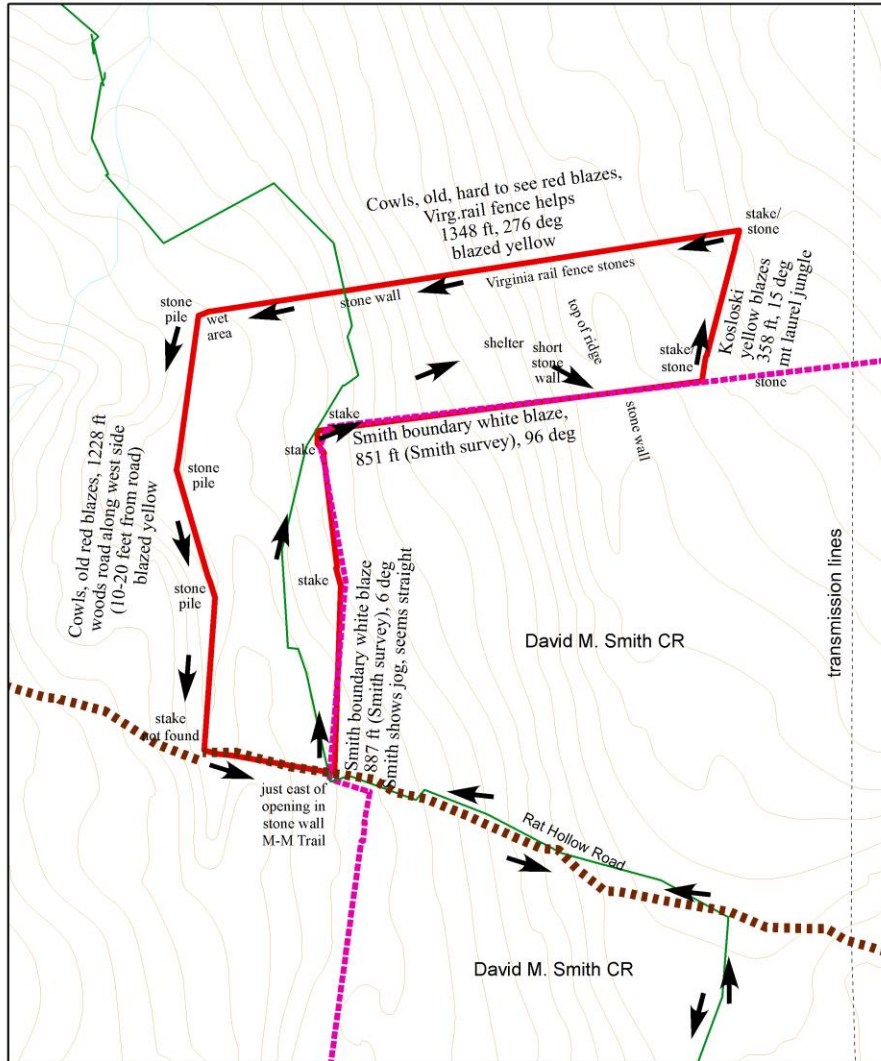

Mosher Conservation Area for Monitoring

0 0.05 0.1 Miles



Arrows shows approximate route of our counter-clockwise walk on August 31, 2014 (neither gps unit was working properly). Yellow painting (8/19 and 8/24) simply followed north and then west line.