

Property: Kuzmeski Conservation Restriction	Year of this Report: 2013
Owner: name, address, phone, email if relevant (Also name of local contact if relevant.):	
Paul W. Kuzmeski 7204 Harbor View Drive Leesburg, FL 34788	
Date owner invited to monitoring:	
Owner does not live in the area	
Date and recommendations from last year's monitoring:	
October 27 and November 3, 2012 East and west boundaries need to be re-marked.	
Date of this year's monitoring:	
August 31, 2013	
Participants:	
Steve Weiss and Mary Alice Wilson	
Brief description of route taken (also draw on map):	
Beginning at the southwest corner we walked the southern boundary line to the south east corner of the property, then west along the eastern boundary line to the northeast corner. From there we walked the northern boundary line to the northwest corner, crossed Roaring Brook at the bridge, walked back to the western boundary line and walked along it to re-establish the location of that line.	
Describe any man-made alterations (include on map, add photograph or "none observed"):	
None observed	
Describe any interactions (on day of site visit or in past year) with landowner or others having use of the land:	
None.	

Describe any changes in use being planned (change of ownership, land use, etc.):

None that we know.

List observations, comments, management needs, information requests, areas needing discussion or review:

We tied new flagging tape at points along the boundary lines where painting was not feasible, and painted white blazes along the eastern and western boundary lines.

We picked up trash along Cushman Road.

List any needed follow-up:

Ask Sheila and Michael Seaman (neighbors abutting the property to the east) to check the blazes along the eastern boundary line to be sure that they conform to their understanding of the property line.

Suggestions for next year's monitoring team?

Bring work gloves, clippers, a bag for trash, flagging tape, and white spray paint.

Continue to mark the line and pick up roadside trash.

Signed:

Date signed:

..... **Date report to RGT Board:** **Date copy sent to owner:**

..... **Date copy given for archive:**

Kuzmeski Conservation Restriction Monitoring Map

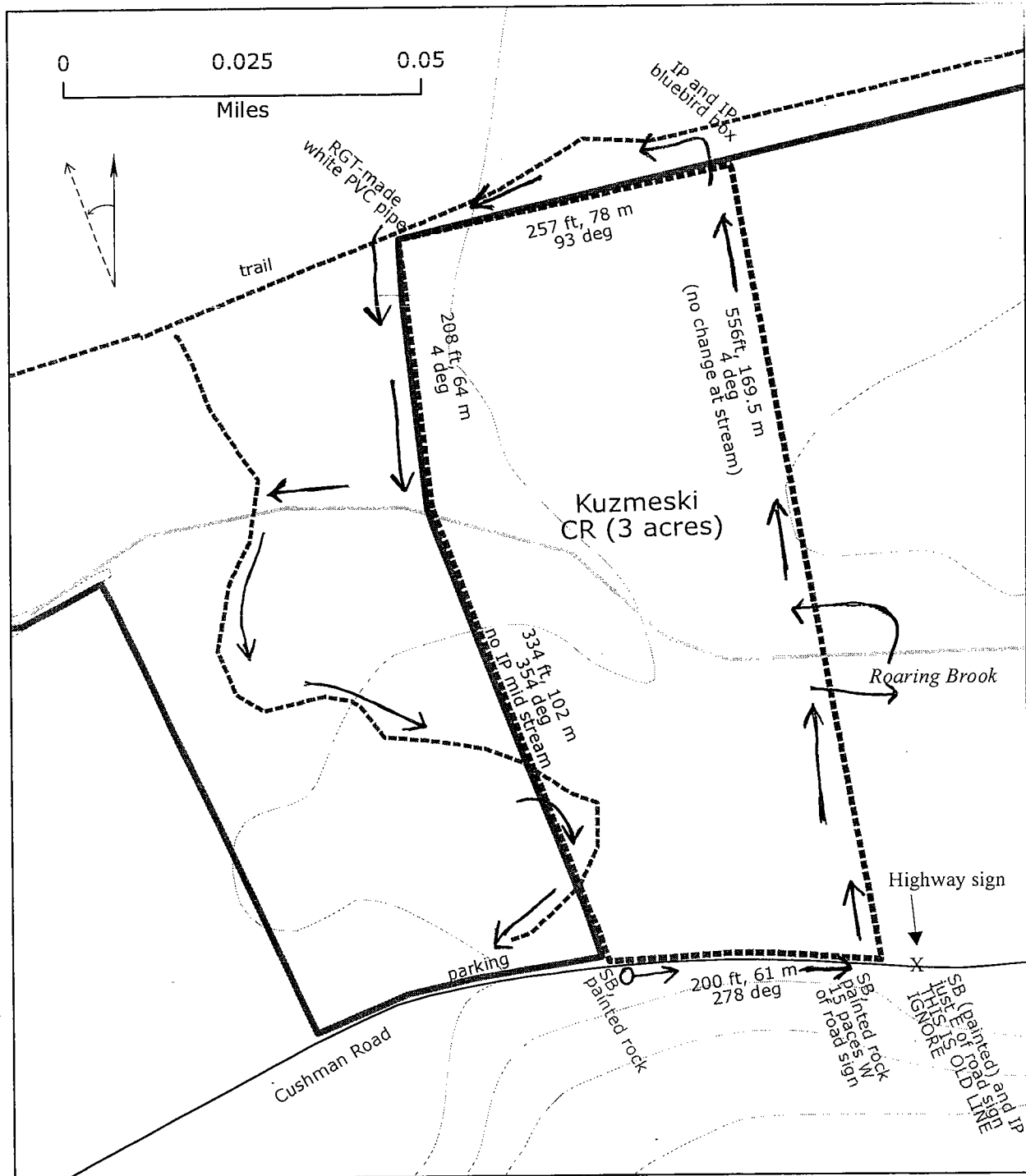

SW corner: 42.43717837, -72.48593118 (at road line with ELM)
 SE corner 42.4372612, -72.48516759 (at road line with Seaman-Williams)
 NW corner 42.43860623, -72.48652571(at meadow line with ELM)
 NE corner 42.43872735, -72.48556598 (at meadow line with Seaman-Williams)

IP - iron pin (surveyor's pin)
 SB = stone bound