

**Rattlesnake Gutter Trust
Monitoring Report**

Property/Conservation Restriction Name: **Kuzmeski Conservation Restriction**
Date of visit(s): **November 21, 2010** CR? **Yes** Owned by RGT? **No**

IF CR please complete this information, if owned property skip to #1:

Current owner(s): **Paul W. Kuzmeski**

Address(es): **Buttercup Lane, Auburn, Maine 04210**

Telephone:

Email:

Local Contact if different from owner:

1. In preparation for the visit

a. date of previous visit: **December 19, 2009**

b. special concerns listed from previous visits that need to be checked:

Regular need to collect trash along the road.

c. If CR, was the land owner contacted prior to monitoring? (if yes, give date and whether by phone, email, etc; if not, why not?)

No. Lives in Maine.

2. Participants attending site visit:

Steve Weiss, Mary Alice Wilson

3. Please use monitoring map (attached) to

a. show the path of the visit

b. mark any issues brought up in this report.

c. suggest changes in information on next year's map

Monitors made careful note of the corner boundary markers and took steps to make them readily visible.

Southwest corner (waypoint 543; stone marker painted red; photo taken from across the road looking north).

Southeast corner (waypoint 544; 16 paces west of the road sign; stone marker painted red; photo from across the road looking north).

Archive Notebook copy _____ Field Notebook copy _____ If CR, owner's copy _____

Northwest corner (waypoint 545; white PVC pipe).

Northeast corner (waypoint 546; stone by birdhouse and post).

4. Describe any man-made alterations since the last monitoring visit. Describe extent, location, purpose, and person responsible (if known). Mark on attached map; add photographs or illustrations if helpful. (Be sure to check roadside areas for possible dumping/disturbance.)

None observed.

5. Describe natural alterations since previous visit (effects of flood, fire, insect infestation, ice damage, etc.) Note extent and location. Mark on attached map; add photographs or illustrations if helpful.

As usual, there was trash by the road along the southern edge of the property, which we picked up.

6. Describe any interactions (on day of site visit or in past year) with landowner or others having use of the land.

None.

7. IF CR, describe any information that property will be transferred, leased, or sold. Are any changes in use being planned?

None to my knowledge.

8. List observations, comments, management needs, information requests, areas needing discussion or review:

Old signs of beaver activity visible.

Considerable number of Barberry visible along the southern side of the stream.

9. List any needed follow-up

None.

Archive Notebook copy _____ Field Notebook copy _____ If CR, owner's copy _____

10. Suggestions for next year's monitoring team?

Corner markers should be located and checked to make sure they remain readily visible.

Trash needs to be picked up along the road at least twice a year.

Signed _____ date _____

Date report submitted to RGT Board for Review: _____

Date report placed in Field Notebook? _____

Date second copy given to RGT Secretary for Archive Notebook? _____

IF CR, date third copy sent to owner ? _____

Kuzmeski Conservation Restriction Monitoring Report November 21, 2010



Solid line = ELM owned by Rattlesnake Gutter Trust (28 acres)
Dotted line = Kuzmeski Conservation Restriction (3 acres)
(land privately owned, with CR held by the Rattlesnake Gutter Trust)
Brown line = edge of meadow and location of trail (about 22 acres)

Kuzmeski Conservation Restriction Monitoring Report November 21, 2010

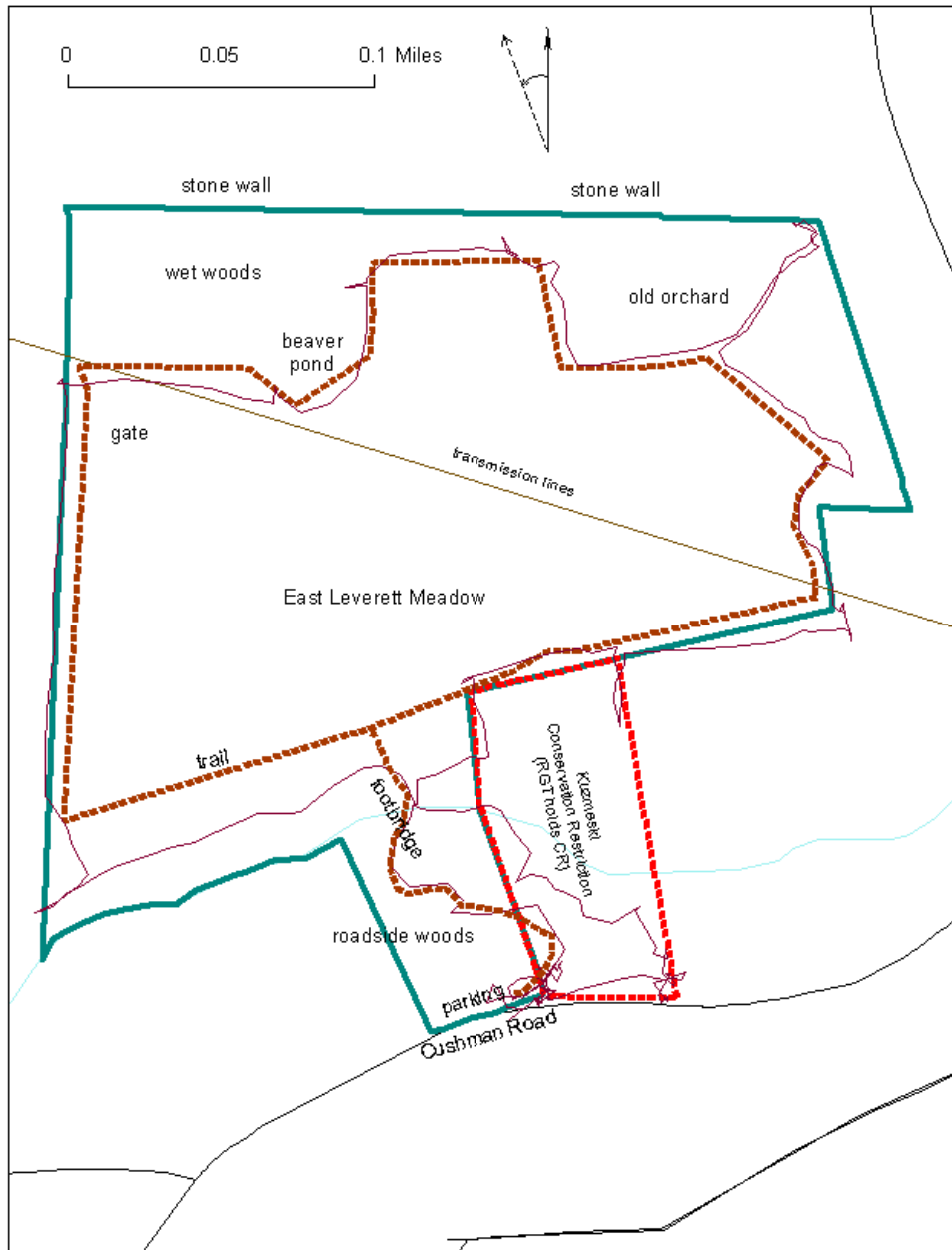

Solid line = ELM owned by Rattlesnake Gutter Trust (28 acres)
Dotted line = Kuzmeski Conservation Restriction (3 acres)
(land privately owned, with CR held by the Rattlesnake Gutter Trust)
Brown line = edge of meadow and location of trail (about 22 acres)



Kuzmeski, NW corner post



Kuzmeski SW corner stone

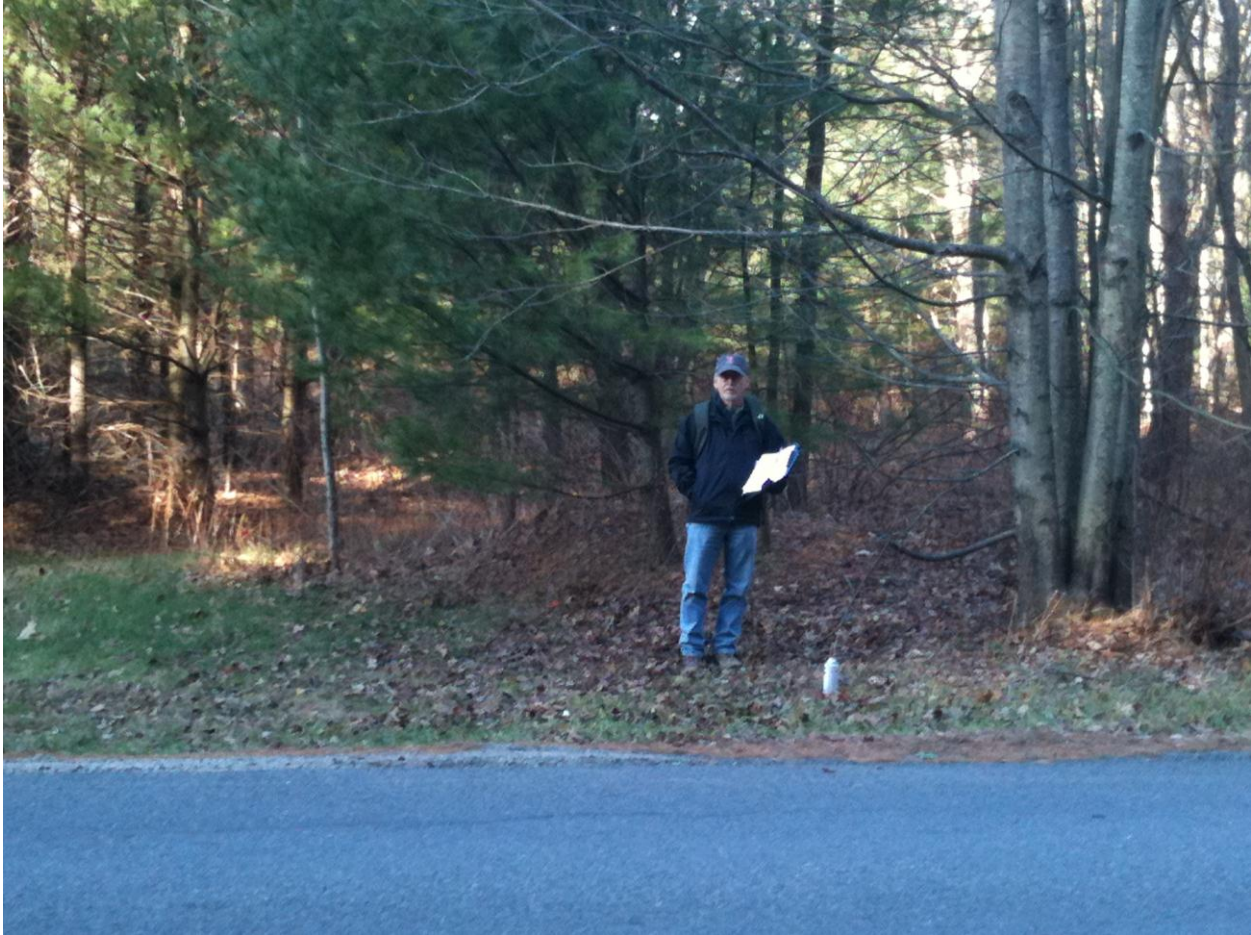

Kuzmeski SW corner stone close-up



Kuzmeski SE corner stone