

Gibavic Family CR for Montoring

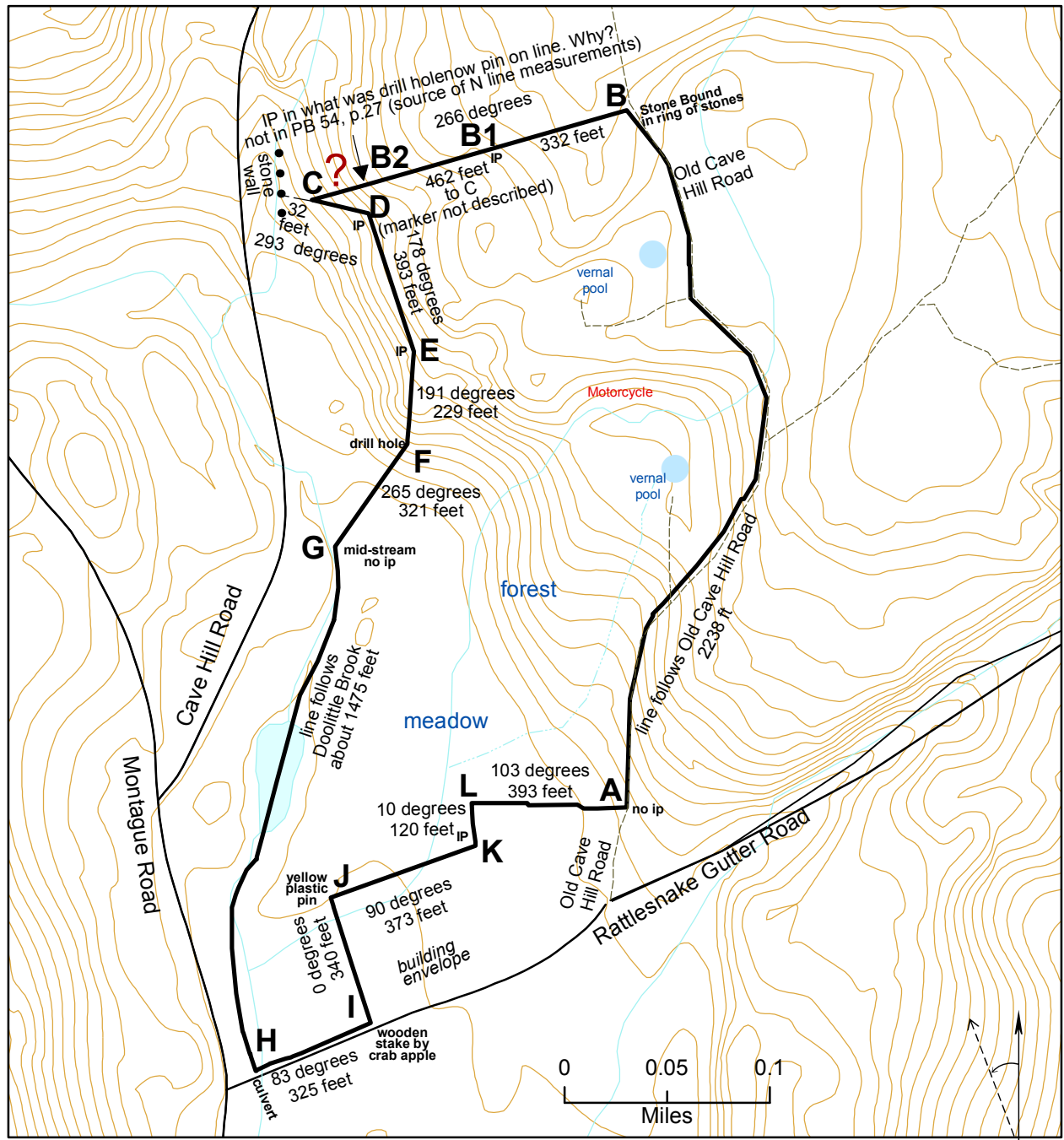

- A. SE corner with Eva Beth Gibavic (survey), 42.47937, -72.49482 (no pin found)
- B. E line Old Cave Hill and Old Whitney Roads to stone marker, 42.48442, -72.49471
- B1. IP along line, 42.484091, -72.496111 (in Lee PB 54 p 27)
- B2. ip surrounded by stones, relatively new, not clear purpose/source. Is on the property line
- C. drill hole on cliff/jumble of rocks, 42.483688, -72.497845. If one were to extend line from C to D to the nw 32 feet, that line would come to stone wall with "lead in boulder" (D.Gibavic PB 54, p. 27)
- D. IP line C to D along cliff edge, pin at edge of ledge, 42.483655, -72.497269 (distance = 134 (D Gibavic PB 59,27) minus 32 (Lee PB 54,27)
- E. Change of angle along west line, surveyor's pin, 42.48267, -72.496879
- F. Corner south of Donald and Nancy Gibavic property, 42.481896, -72.496886 (drill hole)
- G. W edge along brook with Doolittle Brook CA at footbridge, 42.48137, -72.49767 (footbridge gone)
- H. At Rattlesnake Gutter Road at culvert, 42.47748, -72.498210
- I. S line along Rattlesnake Gutter Road turning into field, wooden stake under small tree along stone wall, 42.47876, -72.497593
- J. Inside corner of building envelope in meadow. Yellow pin in grass found occasionally 42.47882, -72.49757
- K. Corner in stone wall, iron pin to right of white quartz rock, 42.47904, -72.49635
- L. Corner of stone wall, 42.47941496, -72.49613213