

## RGT Monitoring Report: Friendship Trail Properties

1. Name of Property and Year: Friendship Trail Properties (3 properties):

David and Mary Field Conservation Area  
Philip and Catherine Woodard Conservation Area  
Carlyle and Edith Field Conservation Area

2. Property owned by RGT? no

a. If "no" (i.e. CR): Name of owner: Leverett Conservation Commission

b. Date owner was invited to join in the monitoring: Nov 5, 2014

3. Date and recommendations from last year's monitoring: October 25, 2013

1. Bring gloves and a large trash bag when you walk along Depot Road.

2. If the blue boundary tags have not been placed, bring them, nails, and a hammer. (The baseline photos should also be carried just to make sure you are in the right place.)

4. Date of this year's monitoring: November 10, 2014

5. Participants: Christine Nelson (ConCom), Mary Alice Wilson (RGT)

6. Describe the monitoring route briefly (also draw on map):

Counter clockwise from Boat Ramp along Friendship Trail west and north. South near line on old woods road and then along Woodard Trail to Depot Road and then east along Depot Road.

We found posts in the stream (SE corner of D&M Field), in the wetland (Woodard NE corner) by the pond (NE corner C&E Field), along the trail (C&E Field NW corner), along Cider Mill Road (D&M Field NW corner - not pin, only yellow plastic stake), by the Woodard Trail (NW corner Woodard), and in the dry stream (SE Woodard Corner). We did not think to look for the iron pipe in the Depot Road stone wall (NW Woodard corner).

7. Describe any man-made alterations (draw on map/take photos. If no, write "none observed")

none observed

8. Describe any natural alternations:

some trees down (as there are every year), but nothing dramatic noticed

9. If CR, describe any interactions with landowner(s) during the monitoring or since the past monitoring:

In September 2013, Olivia Bernard requested permission from RGT and the ConCom to do the same view-cutting (cutting the tops off fast-growing shrubs) that she has done every few years. As in the past, RGT said that the cutting does not damage the conservation value of the land - indeed enhances it because dense shrubby areas are excellent (and rare) habitat for birds and other critters. She received permission and the cutting was done.

10. Describe any changes in use being planned (ownership? land use?):

none known

11. List any observations comments, areas needing discussion or review:

trails are well-maintained by neighbors  
signs honoring the 3 families who owned the land would be nice  
the blue (town) metal border tags have not been installed

12. List any needed follow-up:

perhaps signs this year (Chris Nelson donated a wonderful cedar post for the Philip and Catherine Woodard sign.)

13. Suggestions for next year's monitoring team?

Bring gloves and trash bag for walk along the road.

Bring orange ribbon to re-mark the corner posts.

If blue tags are to be installed, bring gps shape file, map, and photos of corners (as well as tags, hammer and aluminum nails). Line has already been painted. (Should have the gps file, map and photos anyway).

If all 3 signs not installed, consider doing that.

Signed: \_\_\_\_\_

Date Signed:

AND

- \_\_\_ I have asked to present this report at the next RGT Board Meeting.
- \_\_\_ I have sent a copy of this report to the owner (if CR).
- \_\_\_ I have printed out a copy of this report and put it in the RGT green Field Notebook.
- \_\_\_ I have sent a copy to the person who puts reports in the RGT blue Archive Notebook.
- \_\_\_ I have sent an electronic copy of this report to the person who puts it on the Board-only section of the RGT website.

## Friendship Trail Monitoring Map (all 3 properties)

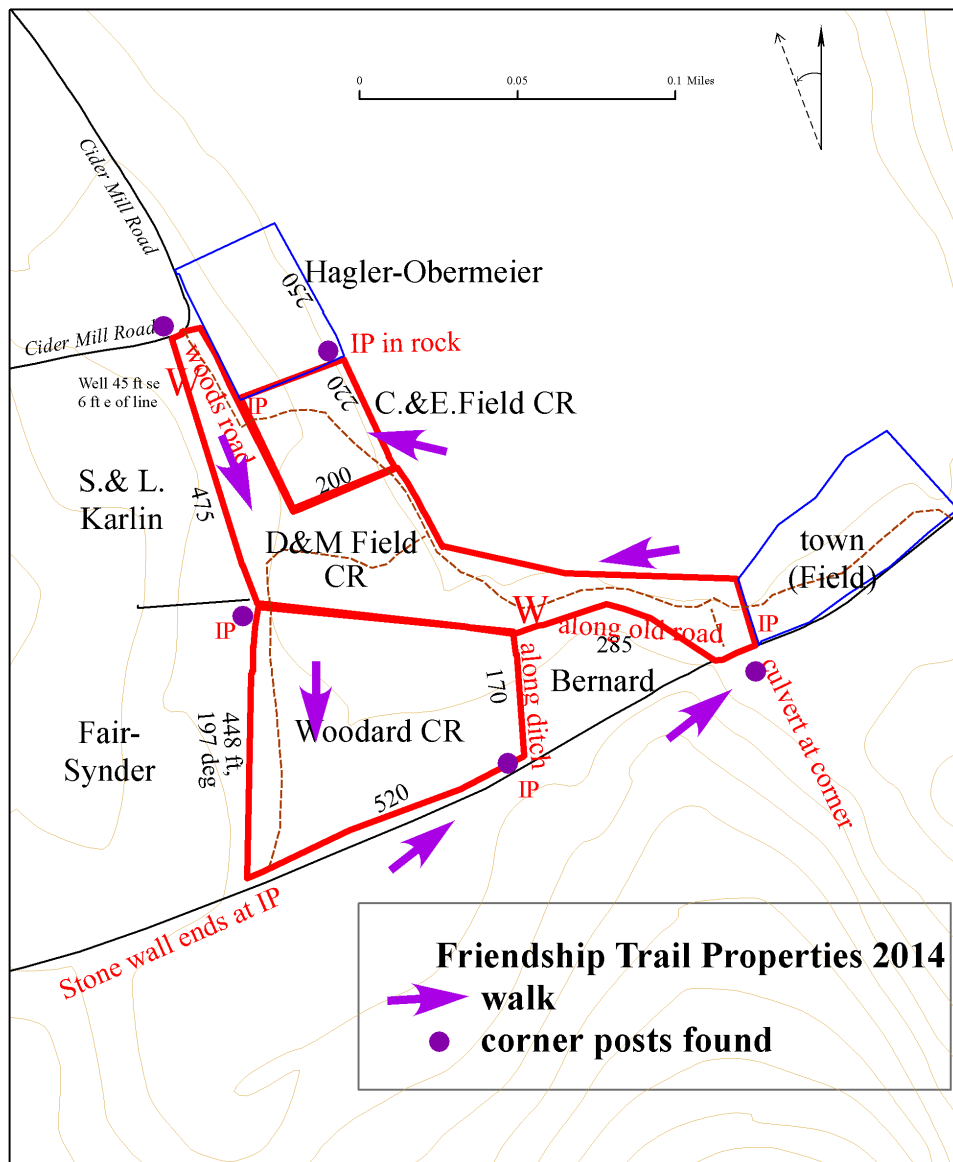

Woodard - iron pins on 3 corner, NE painted red/flagged. Non-road borders painted.  
David and Mary Field - iron pins on SW corner and east corner in brook, rest marked with red paint/flagging. Use baseline pictures and description for Bernard line.  
Carlyle and Edith Field - iron pins on north corners, rest abuts D&M Field property.