

## Bates Monitoring Report 2014

1. Name of Property and Year: Donald H. Bates Sanctuary, 2014

2. Property owned by RGT? yes

3. Date and recommendations from last year's monitoring:

(first year, last year baseline data only.)

4. Date of this year's monitoring: November 2, 2014

5. Participants:

Rocky Adriance (RGT), Mary Barnett (RGT), Kathy Campbell (neighbor), George and Betty Lockwood (neighbor), Mary Alice Wilson (RGT)

6. Describe the monitoring route briefly (also draw on map): Since Mary Alice managed to leave the gps unit in her car, the map only shows directional arrows. We walked

from the Lockwood's to the NE corner (pond);  
along the north line (first bordering Campbell then the town's Roaring Brook Conservation Area);  
along the west line which is also the old M-M trail;  
back along the trail that is very near the actual boundary along Lancaster Pike Road.

We then walked north on the trail (rather than the washed-out discontinued road/boundary);  
turned up the knoll trail and enjoyed Mary's wonderful bench at the top (photos);  
back down the knoll trail and down to the Lockwood's house.

7. Describe any man-made alterations (draw on map/take photos.)

Loop and knoll trail completed this past year. Donald H. Bates bench placed at the top of the knoll.

Some use of the loop trail by ATV (can see marks, not major damage)

8. Describe any natural alternations:

none observed

9. If CR, describe any interactions with landowner(s) during the monitoring or since the past monitoring: NA

10. Describe any changes in use being planned (ownership? land use?): none

11. List any observations comments, areas needing discussion or review:  
Trail.

The present trail markings are quite bright - too bright? Group felt they were fine and would fade a bit over time. (And late afternoon walk confirmed that bright is OK.)

New bog bridges on the trail leading from Shutesbury Road are a great improvement. Thanks to the Leverett Trails Committee and RGT for paying for the lumber.

One more trail through Campbell land to the knoll was planned. It was for dog-walking neighbors and never to be put on the map. However, it is very steep at the north end. On Kathy's recommendation, we decided to delay for a year and re-assess whether it is necessary.

Extending the trail east along Lancaster Pike? Interesting idea - this old public road (county road, never discontinued) is less eroded once it gets to the top of the hill.

ATV use. While not causing erosion problems at the moment, RGT Board needs to include this property in its discussion of an overall "motorized vehicle" policy. Final policy/practice needs to be discussed by Bates Property Committee (board members and neighbors)

Boundary marking: still visible (north boundary is only one that is not easy to find) It will need to be repainted in a few years. Having the photographs of the many corner posts was helpful.

12. List any needed follow-up:

none.

13. Suggestions for next year's monitoring team?

Bring map, photographs of boundary corners, and gps with Bates shapefile. Enjoy this lovely property (but expect to get wet feet along the north line).

Signed: \_\_\_\_\_

Date Signed:

AND

I have asked to present this report at the next RGT Board Meeting.

I have sent a copy of this report to the owner (if CR).

I have printed out a copy of this report and put it in the RGT green Field Notebook.

I have sent a copy to the person who puts reports in the RGT blue Archive Notebook.

I have sent an electronic copy of this report to the person who puts it on the Board-only section of the RGT website.



from top: talking about history of land use; new bog bridges; switching mis-placed "you are here" maps' the bench: aft and fore

(It was hunting season.)





# Donald H. Bates Sanctuary Monitoring Map

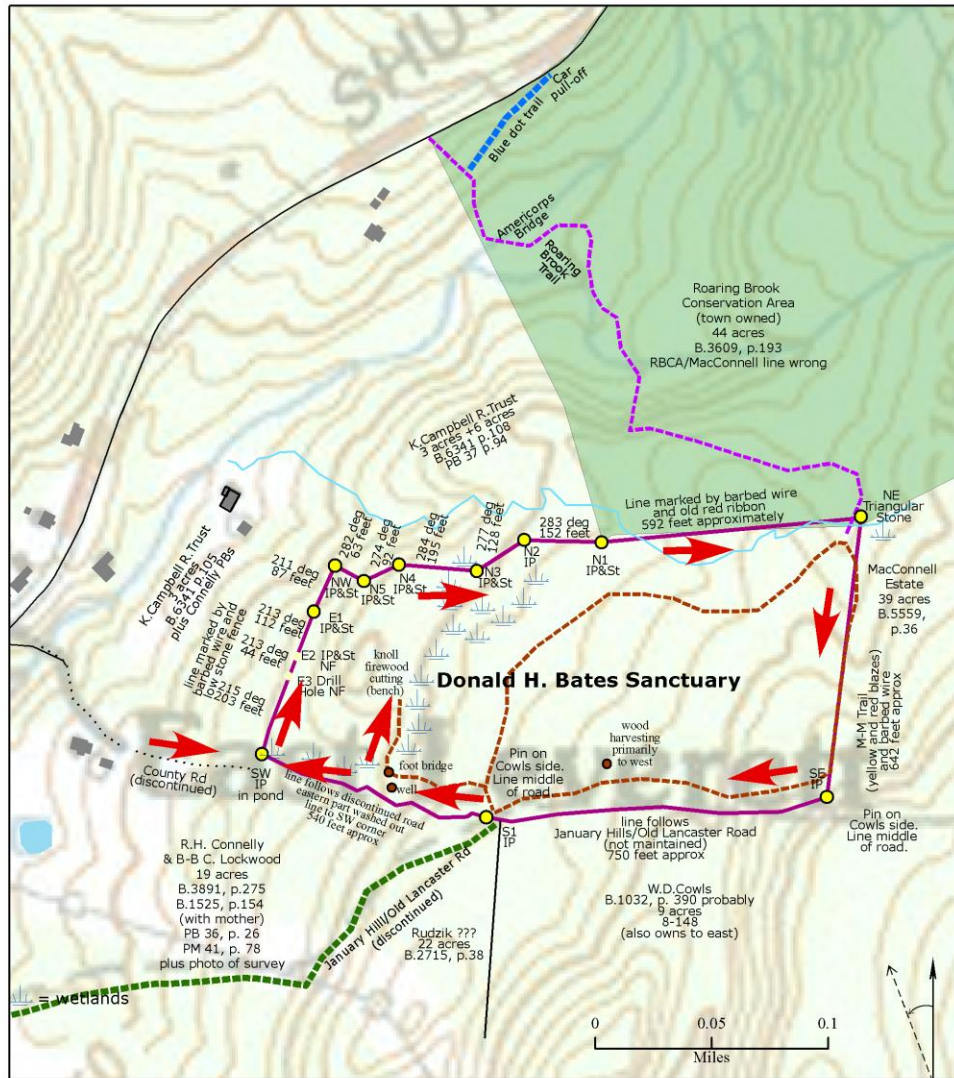

This map is designed to be used with the excel chart and the accompanying photographs of the Bates boundaries which can be found in the Baseline Report.

While there is legal access to the property along the discontinued county road (Connelly driveway), please park your car on Shutesbury Road and walk the 0.3 mile to the property on the Roaring Brook (formerly M-M) Trail. Or walk January Road up Lancaster Pike.

If you do need to go through the Connelly driveway, please contact them ahead of time and park in the space before the bridge. Do not park in the driveway to the Campbell home.

Note: this map is for monitoring, it is not a legal description of the property.